

QB-CF150-P-10

Metal Pipe penetrating a rigid floor (150mm or thicker)



This standard detail is intended for general information only and all details should be checked against all relevant supporting test evidence, certification and installation guidelines. In line with the company's policy of continual development, details are subject to change and/ or withdrawal therefore you must ensure this is the latest published detail and instructions.

Additional Instructions
 The floor must have a minimum thickness of 150mm and comprise of concrete, aerated or concrete, with a minimum density of 670kg/m³.
 Multiple Service Penetrations: The total amount of cross section area of the services (including insulation) should not exceed 60% of the service penetration area.

Additional Instructions
 Pipes can be installed at an angle between 45 - 89° as per BS EN 1366-3:2021 section E.4.2.6

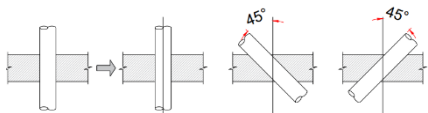
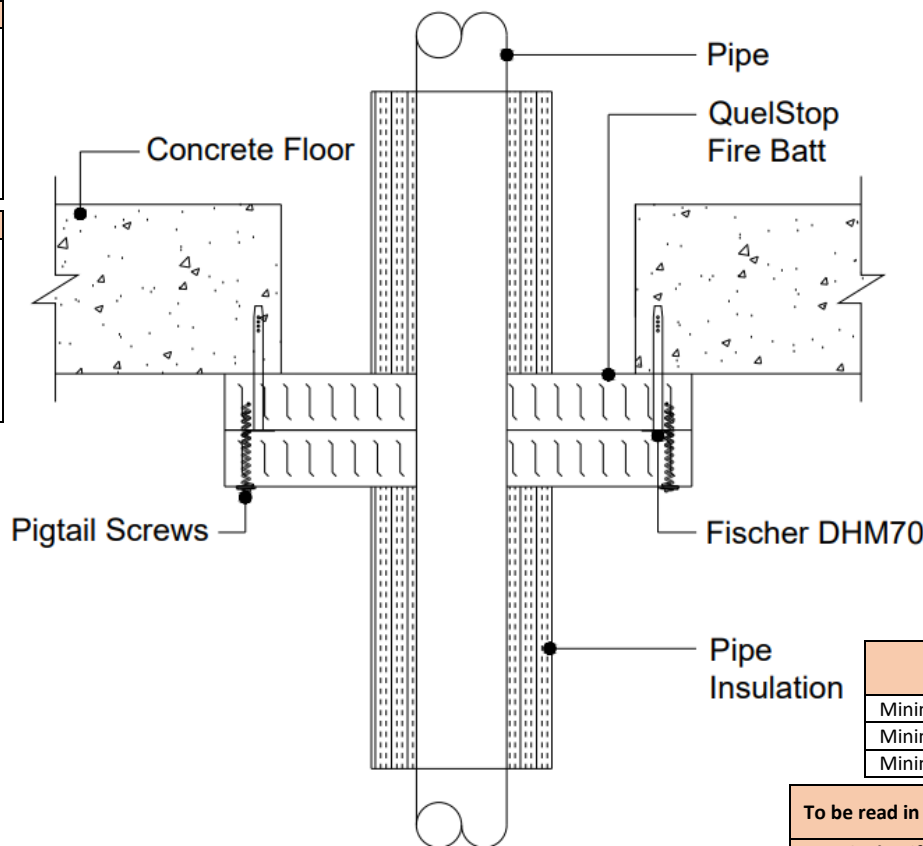
Quelfire Products Required	
Product Code	Description
QB50D	Quelfire Fire Batt
QSS310	Quelfire Intumescent Acrylic Sealant
QSC5KG	Quelfire Ablative Coating 5kg tub
QFFDW	Foil faced rock fibre insulation
Fixings	Select correct substrate fixing

Quelfire Fire Batt Fixing Instruction
 Follow the installation steps referenced in the [Quelfire Fire Batt installation guidance](#) document.
 Quelfire Fire Batt overlap to substrate is ≥100mm on all sides.
 First Quelfire Fire Batt layer bedded to the slab using Quelfire Acrylic Sealant and mechanically fixed using the following fixing types depending on aperture size. 6mm x 100mm countersunk concrete screws with 25mm dia. steel retaining washers for apertures up to 600mm x 500mm. Fischer DHM 70 insulation fixings for apertures up to 1000mm x 1300mm. Fixings installed in the centre of the Quelfire Fire Batt overlap at maximum 250mm centres and in every corner of the Quelfire Fire Batt Seal. Second Quelfire battress layer fixed to the first layer using Quelfire 90mm long pigtail screws.

Multiple Service Penetration Spacing	
Distances are from edge of fire stop seal	
Minimum distance from edge of opening	0mm
Minimum distance between Services within the table shown	0mm
Minimum distance between other Service types	100mm

Detail	Page No.
Underside 1100 x 1300mm	1
Underside 500 x 400mm	2
Topside	3

Service Type	Size of Services	Pipe Wall Thickness	Pipe Insulation	Classification
Copper/ Cast Iron & Steel Pipe*	≤Ø42mm	1.2 - 14.2mm	≥40mm thick foil faced rock fibre insulation ≥40kg/m ³ density (L/I 300mm)	EI 60 C/U
	Ø42 - 159mm	2.0 - 14.2mm		E 60 C/U EI 30 C/U

* All metal pipe materials are covered which have a thermal conductivity equal or lower than the metal pipe tested and provided the melting point is at least equal or greater.

To be read in conjunction with:	UL Classification Report 4790517197 Issue 3 , Pages 282, 283 & 314
Test & Classification standard:	BS EN1366-3 & EN13501-2
Substrate minimum thickness:	150mm
First Service Support:	≤400mm
Maximum Aperture:	1000mm wide x 1300mm long
Drawing Scale:	Not to Scale
Issue Number:	2
Date of Issue:	September 2023
Detail Reference:	QB-CF150-P-10

Important Information:

- The supporting construction must be installed in accordance with the manufacturer's guidelines and must be capable of achieving the required fire rating of the firestop.
- All services should be adequately supported on both sides of the firestop to ensure that no load is transferred onto the firestop seal.

Scope and Liability:

- Any information provided by or on behalf of Quelfire Limited is provided for general information only. It is not intended to amount to advice on which you should rely. You must obtain professional or specialist advice before taking, or refraining from, any recommendation or action.
- The summary is not exhaustive and does not consider all issues relevant to the enquiry. It is limited to the information and time available to us. We have not verified any information made available to us by you or any other source, nor have we carried out a physical inspection of any property. We make no representations, warranties or guarantees, whether expressed or implied, that any information is accurate, complete or up to date.
- We do not accept a duty of care to you or any other person in respect of the enquiry, nor do we accept any liability to you or any other person for any loss arising out of or in connection with the enquiry or any reply provided by us. Different limitations and exclusions of liability arising as a result of the supply of any products or services by us to you, and these will be set out in our terms and conditions of supply, a copy of which is available on request.
- Full terms and conditions of sale are available at <https://www.quelfire.co.uk/terms-conditions-of-sale/>

QB-CF150-P-10

Metal Pipe penetrating a rigid floor (150mm or thicker)



This standard detail is intended for general information only and all details should be checked against all relevant supporting test evidence, certification and installation guidelines. In line with the company's policy of continual development, details are subject to change and/ or withdrawal therefore you must ensure this is the latest published detail and instructions.

Additional Instructions
 The floor must have a minimum thickness of 150mm and comprise of concrete, aerated or concrete, with a minimum density of 670kg/m³.
 Multiple Service Penetrations: The total amount of cross section area of the services (including insulation) should not exceed 60% of the service penetration area.

Additional Instructions
 Pipes can be installed at an angle between 45 - 89° as per BS EN 1366-3:2021 section E.4.2.6

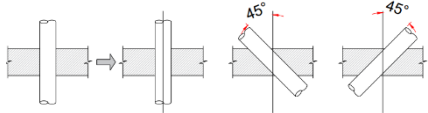
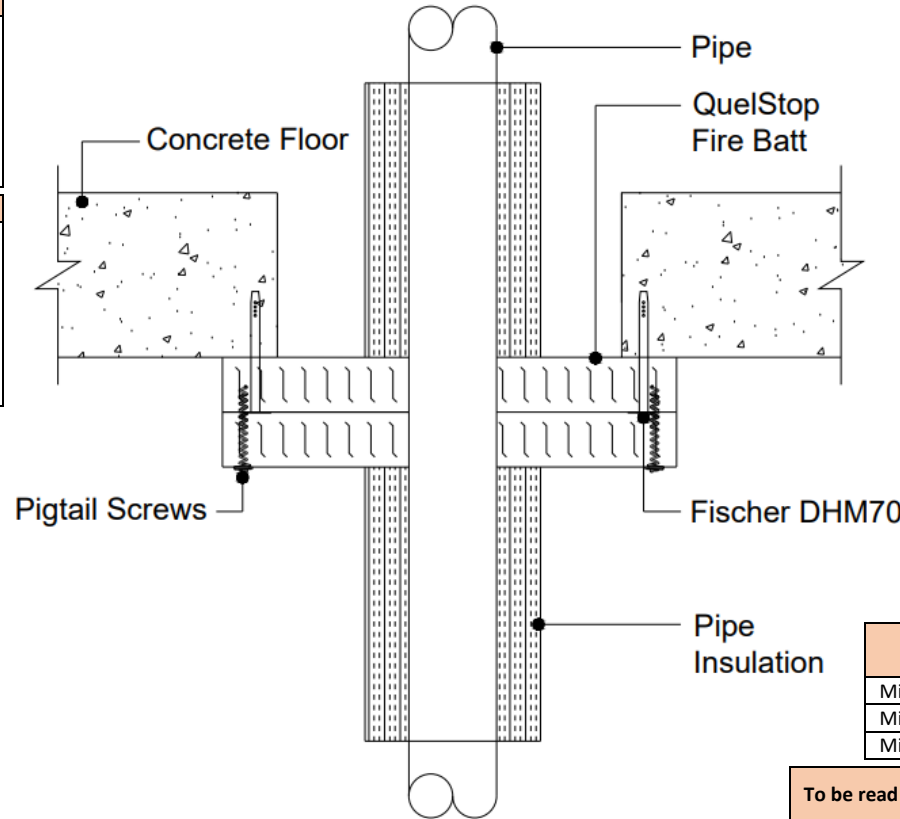
Quelfire Products Required	
Product Code	Description
QB50D	QuelStop Fire Batt
QSS310	QuelStop Intumescent Acrylic Sealant
QSC5KG	QuelStop Ablative Coating 5kg tub
QFFDW	Foil faced rock fibre insulation
Fixings	Select correct substrate fixing

QuelStop Fire Batt Fixing Instruction
 Follow the installation steps referenced in the [QuelStop Fire Batt installation guidance](#) document.
 QuelStop Fire Batt overlap to substrate is ≥50mm on all sides. First QuelStop Fire Batt layer bedded to the slab using QuelStop Acrylic Sealant and mechanically fixed using 6mm x 100mm countersunk concrete screws with 25mm dia. steel retaining washers. Fixings installed in the centre of the QuelStop Fire Batt overlap at maximum 250mm centres and in every corner of the QuelStop Fire Batt Seal. Second QuelStop pattress layer fixed to the first layer using Quelfire 90mm long pigtail screws.

Multiple Service Penetration Spacing	
Distances are from edge of fire stop seal	
Minimum distance from edge of opening	0mm
Minimum distance between Services within the table shown	0mm
Minimum distance between other Service types	100mm

Detail	Page No.
Underside 1100 x 1300mm	1
Underside 500 x 400mm	2
Topside	3

Service Type	Size of Services	Pipe Wall Thickness	Pipe Insulation	Classification
Copper/ Cast Iron & Steel Pipe*	≤Ø42mm	1.2 - 14.2mm	≥40mm thick foil faced rock fibre insulation ≥40kg/m ³ density (L/I 300mm)	E 90 C/U
	Ø42 - 159mm	2.0 - 14.2mm		E 90 C/U EI 30 C/U

* All metal pipe materials are covered which have a thermal conductivity equal or lower than the metal pipe tested and provided the melting point is at least equal or greater.

To be read in conjunction with:	UL Classification Report 4790517197 Issue 3 , Pages 282, 283 & 315
Test & Classification standard:	BS EN1366-3 & EN13501-2
Substrate minimum thickness:	150mm
First Service Support:	≤400mm
Maximum Aperture:	500mm wide x 400mm long
Drawing Scale:	Not to Scale
Issue Number:	2
Date of Issue:	September 2023
Detail Reference:	QB-CF150-P-10

Important Information:

- The supporting construction must be installed in accordance with the manufacturer's guidelines and must be capable of achieving the required fire rating of the firestop.
- All services should be adequately supported on both sides of the firestop to ensure that no load is transferred onto the firestop seal.

Scope and Liability:

- Any Information provided by or on behalf of Quelfire Limited is provided for general information only. It is not intended to amount to advice on which you should rely. You must obtain professional or specialist advice before taking, or refraining from, any recommendation or action.
- The summary is not exhaustive and does not consider all issues relevant to the enquiry. It is limited to the information and time available to us. We have not verified any information made available to us by you or any other source, nor have we carried out a physical inspection of any property. We make no representations, warranties or guarantees, whether expressed or implied, that any information is accurate, complete or up to date.
- We do not accept a duty of care to you or any other person in respect of the enquiry, nor do we accept any liability to you or any other person for any loss arising out of or in connection with the enquiry or any reply provided by us. Different limitations and exclusions of liability arising as a result of the supply of any products or services by us to you, and these will be set out in our terms and conditions of supply, a copy of which is available on request.
- Full terms and conditions of sale are available at <https://www.quelfire.co.uk/terms-conditions-of-sale/>

QB-CF150-P-10

Metal Pipe penetrating a rigid floor (150mm or thicker)



This standard detail is intended for general information only and all details should be checked against all relevant supporting test evidence, certification and installation guidelines. In line with the company's policy of continual development, details are subject to change and/ or withdrawal therefore you must ensure this is the latest published detail and instructions.

Additional Instructions
 The floor must have a minimum thickness of 150mm and comprise of concrete, aerated or concrete, with a minimum density of 670kg/m³.
 Multiple Service Penetrations: The total amount of cross section area of the services (including insulation) should not exceed 60% of the service penetration area.

Additional Instructions
 Pipes can be installed at an angle between 45 - 89° as per BS EN 1366-3:2021 section E.4.2.6

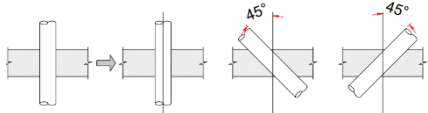
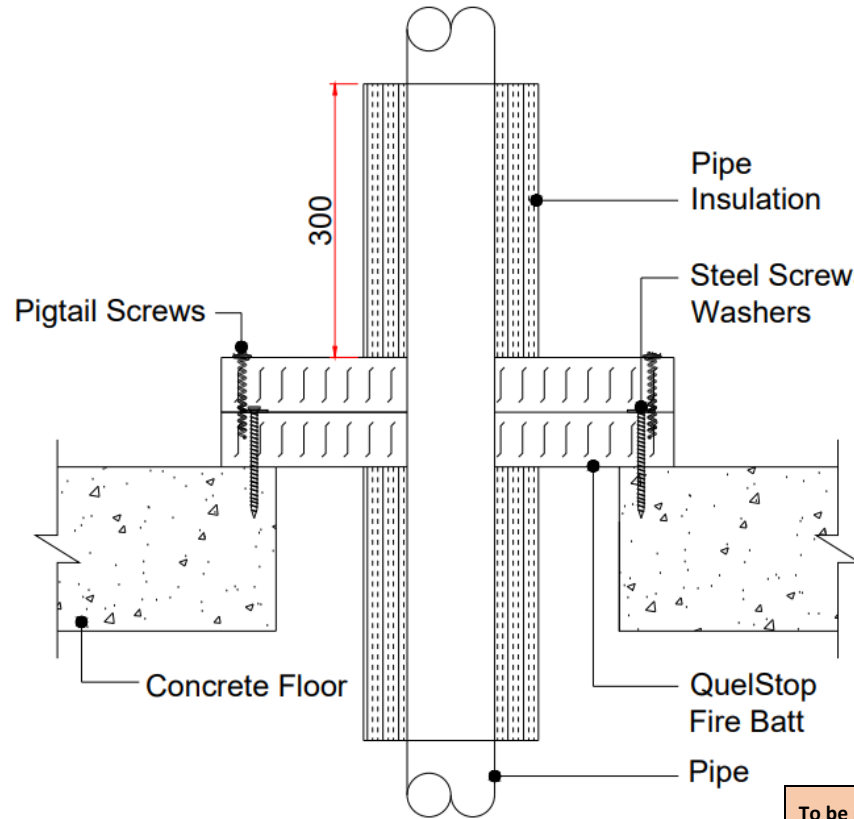
Quelfire Products Required	
Product Code	Description
QB50D	QuelStop Fire Batt
QSS310	QuelStop Intumescent Acrylic Sealant
QSC5KG	QuelStop Ablative Coating 5kg tub
QFFDW	Foil faced rock fibre insulation
Fixings	Select correct substrate fixing

QuelStop Fire Batt Fixing Instruction
 Follow the installation steps referenced in the [QuelStop Fire Batt installation guidance](#) document.
 QuelStop Fire Batt overlap to substrate is ≥250mm on all sides. First QuelStop Fire Batt layer bedded to the slab using QuelStop Acrylic Sealant and mechanically fixed using the following fixing types depending on aperture size. 6mm x 100mm countersunk concrete screws with 25mm dia. steel retaining washers. Fixings installed in the centre of the QuelStop Fire Batt overlap at maximum 250mm centres and in every corner of the QuelStop Fire Batt Seal. Second QuelStop pattress layer fixed to the first layer using Quelfire 90mm long pigtail screws.

Multiple Service Penetration Spacing	
Distances are from edge of fire stop seal	
Minimum distance from edge of opening	0mm
Minimum distance between Services within the table shown	0mm
Minimum distance between other Service types	100mm

Detail	Page No.
Underside 1100 x 1300mm	1
Underside 500 x 400mm	2
Topside	3

Service Type	Size of Services	Pipe Wall Thickness	Pipe Insulation	Classification
Copper/ Cast Iron & Steel Pipe*	≤Ø42mm	1.2 - 14.2mm	≥40mm thick foil faced rock fibre insulation ≥40kg/m ³ density (L/I 300mm)	E 90 C/U EI 60 C/U
	Ø42 - 159mm	2.0 - 14.2mm		E 90 C/U EI 30 C/U

* All metal pipe materials are covered which have a thermal conductivity equal or lower than the metal pipe tested and provided the melting point is at least equal or greater.

To be read in conjunction with:	UL Classification Report 4790517197 Issue 3 , Pages 282, 283 & 316
Test & Classification standard:	BS EN1366-3 & EN13501-2
Substrate minimum thickness:	150mm
First Service Support:	≤400mm
Maximum Aperture:	500mm wide x 400mm long
Drawing Scale:	Not to Scale
Issue Number:	2
Date of Issue:	September 2023
Detail Reference:	QB-CF150-P-10

Important Information:

- The supporting construction must be installed in accordance with the manufacturer's guidelines and must be capable of achieving the required fire rating of the firestop.
- All services should be adequately supported on both sides of the firestop to ensure that no load is transferred onto the firestop seal.

Scope and Liability:

- Any Information provided by or on behalf of Quelfire Limited is provided for general information only. It is not intended to amount to advice on which you should rely. You must obtain professional or specialist advice before taking, or refraining from, any recommendation or action.
- The summary is not exhaustive and does not consider all issues relevant to the enquiry. It is limited to the information and time available to us. We have not verified any information made available to us by you or any other source, nor have we carried out a physical inspection of any property. We make no representations, warranties or guarantees, whether expressed or implied, that any information is accurate, complete or up to date.
- We do not accept a duty of care to you or any other person in respect of the enquiry, nor do we accept any liability to you or any other person for any loss arising out of or in connection with the enquiry or any reply provided by us. Different limitations and exclusions of liability arising as a result of the supply of any products or services by us to you, and these will be set out in our terms and conditions of supply, a copy of which is available on request.
- Full terms and conditions of sale are available at <https://www.quelfire.co.uk/terms-conditions-of-sale/>